

2 CIRCUIT | 3 CIRCUIT TRACK

120V or 277V



FEATURES

- 120V track or 277V track
- 2 circuit / 2 neutral (separate), 20 amps per circuit, or 3 circuit / 1 neutral, 20 amps per circuit
- Copper Conductor
- Insulated extruded PVC body for conductors
- All Track and connectors provide integrated DATABUS for the control of luminaires makes the system “futureproof”
- Architectural Grade, aluminum extrusion profile
- Black or white powder coat finish
- Field cuttable to required lengths



Date: _____ Type: _____ Catalog Number: _____

Project Name: _____

ORDERING INFORMATION

MODEL	TYPE	CONDUCTOR / VOLTAGE	LENGTH	COLORS
S-9000	SP Surface / Pendant	2C-120 2 circuit - 120V	4 4' Length	W White
	RF Recessed Flanged	2C-277 2 circuit - 277V	8 8' Length	B Black
		3C-120 3 circuit - 120V	12 12' Length	

DIMENSIONS

All dimensions are shown in inches unless otherwise noted.

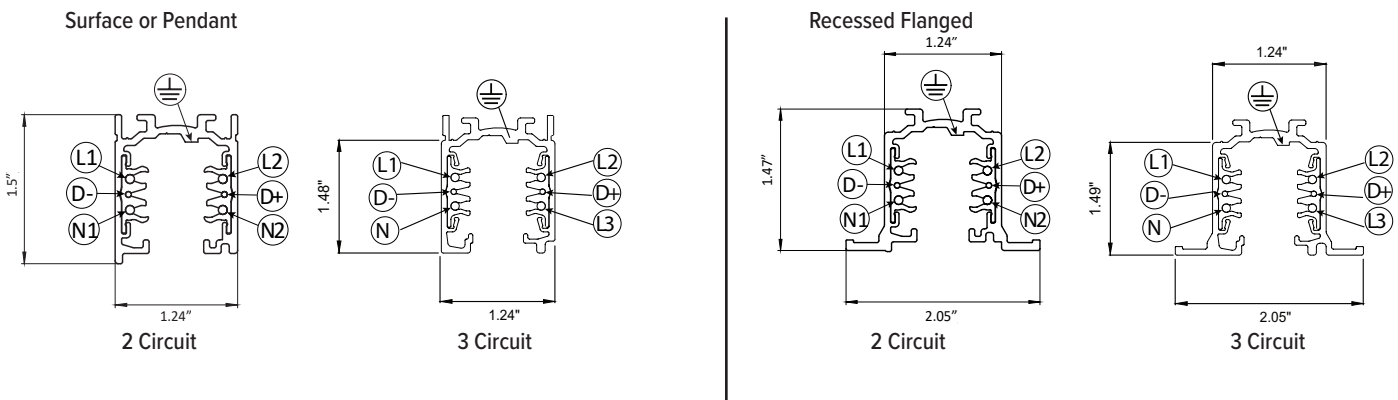

2 CIRCUIT | 3 CIRCUIT TRACK

120V or 277V



All dimensions are shown in inches unless otherwise noted. Available colors: **W** = White, **B** = Black

END FEED

		S- 9001-(color)- 2C-120 2C-277 3C-120	End Feed; Connector; Polarity Right / Earthing Left	
		S- 9002-(color)- 2C-120 2C-277 3C-120	End Feed; Connector; Polarity Left/ Earthing Right	

CONNECTORS

		S- 9003-(color)- 2C-120 2C-277 3C-120	Non-Feed Connector	
		S- 9010-(color)- 2C-120 2C-277 3C-120	Middle Feed; Connector	

L FEED

		S-9011-(color)- 2C-120 2C-277 3C-120	L Feed; Connector; Polarity Internal / Earthing External	
		S-9012-(color)- 2C-120 2C-277 3C-120	L Feed; Connector; Polarity External / Earthing Internal	

2 CIRCUIT | 3 CIRCUIT TRACK

120V or 277V

All dimensions are shown in inches unless otherwise noted. Available colors: **W** = White, **B** = Black

T FEED

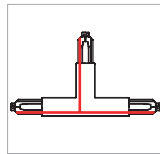

S-9013-(color)- 2C-120
2C-277
3C-120

T Feed; Connector;
Polarity External Left /
Earthing Internal Right

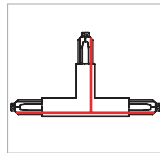

S-9014-(color)- 2C-120
2C-277
3C-120

T Feed; Connector;
Polarity External Right /
Earthing Internal Left

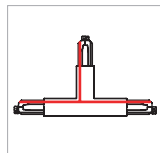

S-9015-(color)- 2C-120
2C-277
3C-120

T Feed; Connector;
Polarity Internal Left /
Earthing External Right

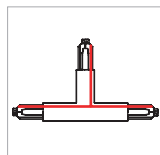

S-9016-(color)- 2C-120
2C-277
3C-120

T Feed; Connector;
Polarity Internal Right /
Earthing External Left

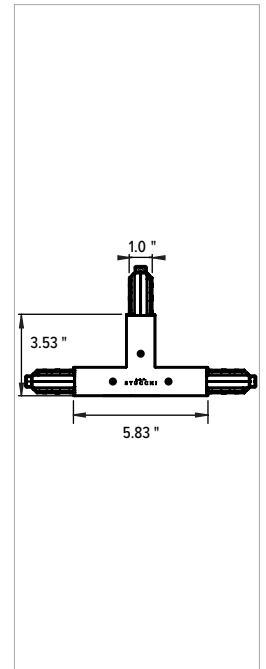

X FEED

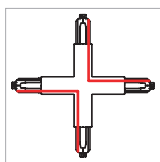
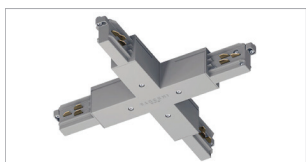

S-9017-(color)- 2C

EndFeed; Connector
Polarity Right/ Earthing Left

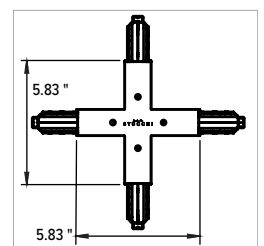

FLEXIBLE CONNECTORS

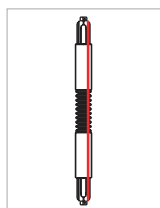
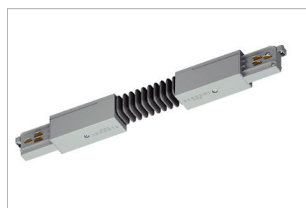

S-9018-(color)- 2C

Adjustable
corner (not to
be used with
recessed track)

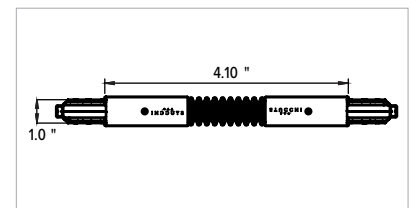

2 CIRCUIT | 3 CIRCUIT TRACK

120V or 277V



All dimensions are shown in inches unless otherwise noted. Available colors: **W** = White, **B** = Black

CURRENT LIMITING DEVICE

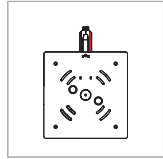
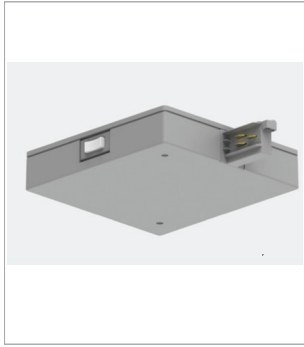

S- 9001-CL(color)-2C-120-AMPS End Feed w/ Circuit Breakers;
2C-277 Polarity Right / Earthing Left
3C-120

0.5A, 1A, 2A, 3A, 4A, 5A, 6A, 7A, 8A, 9A, 10A, 12A and 14A
Other amperage on request.

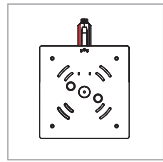
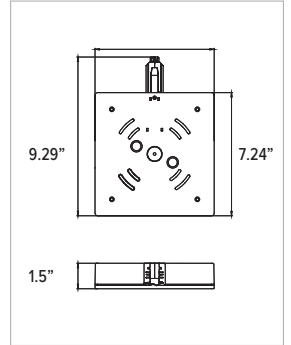

S- 9002-CL (color)-2C-120-AMPS End Feed w/ Circuit Breakers;
2C-277 Polarity Left / Earthing Right
3C-120

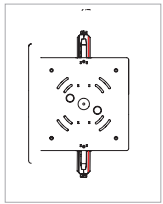

S- 9001-CL(color)-2C-120-AMPS Middle Feed w/ Circuit
2C-277 Breakers
3C-120

0.5A, 1A, 2A, 3A, 4A, 5A, 6A, 7A, 8A, 9A, 10A, 12A and 14A
Other amperage on request.

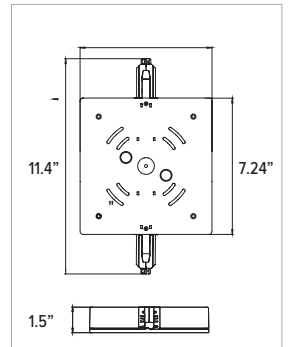

All dimensions are shown in inches unless otherwise noted. Available colors: **W** = White, **B** = Black

END COVERS



S-9004(color)

End Cap with screw
for Surface Track

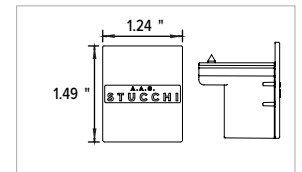

S-9004-R(color)

End Cap with screw
for Recessed Track

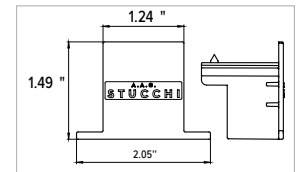

All dimensions are shown in inches unless otherwise noted. Available colors: **W** = White, **B** = Black

FEED COVERS FOR RECESSED TRACK



S-9001-R/6-(color)

Recessed Cover For End Feed

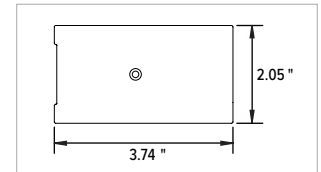

S-9010-R/6-(color)

Recessed Cover For Middle Feed

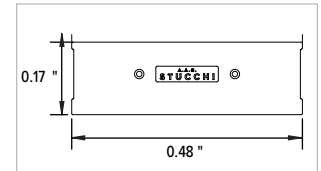

S-9011-R/6-(color)

Recessed Cover For L Feed

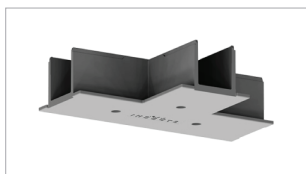
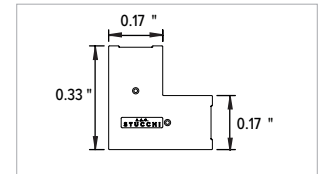

S-9013-R/6-(color)

Recessed Cover For T Feed

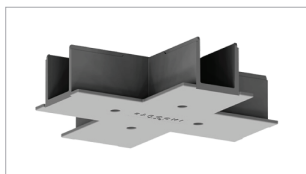
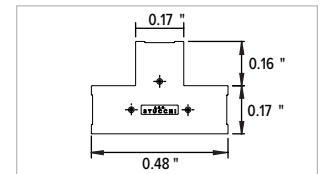

S-9017-R/6-(color)

Recessed Cover For X Feed

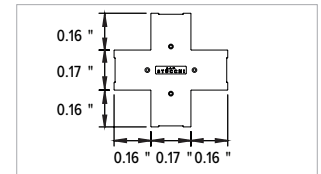

All dimensions are shown in inches unless otherwise noted. Available colors: **W** = White, **B** = Black

BRACKETS



S-9000/312-SV

Short bracket for suspensions

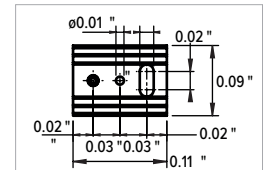

S-9000/322-SV

Medium bracket for suspensions

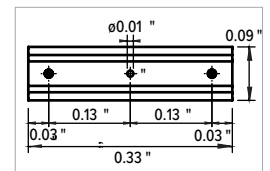

S-9000/332-SV

Long bracket for suspensions

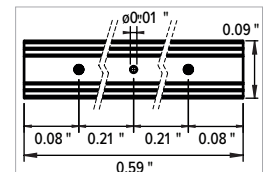

2 CIRCUIT | 3 CIRCUIT TRACK

120V or 277V



Available colors: **W** = White, **B** = Black

COMPLETE SUSPENSION KITS

KEY:	9000-KITx-1.5	=	59" cable
	9000-KITx-3	=	118" cable
	9000-KITx-5	=	197" cable

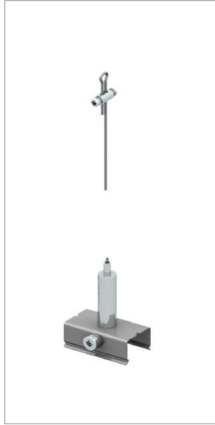

9000-KIT1-1.5
9000-KIT1-3
9000-KIT1-5

Kit Includes

- screw gripper
- steel cable Ø 1.5mm
(L=1500/3000/5000mm)
- clamp with automatic gripper



9000-KIT2-1.5-(color)
9000-KIT2-3-(color)
9000-KIT2-5-(color)

Kit Includes

- ceiling bracket
- screw gripper
- plastic canopy
- steel cable Ø 1.5mm
(L=1500/3000/5000mm)
with spherical end
- fast fixing clamp



9000-KIT3-1.5-(color)
9000-KIT3-3-(color)
9000-KIT3-5-(color)

Kit Includes

- screw gripper
- plastic cup
- steel cable Ø 1.5mm
(L=1500/3000/5000mm)
- bracket with automatic gripper

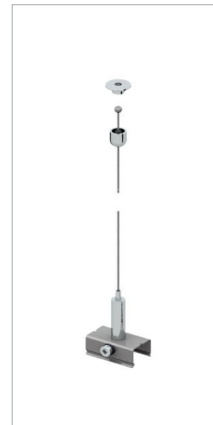

9000-KIT4-1.5
9000-KIT4-3
9000-KIT4-5

Kit Includes

- round head ceiling attachment
- steel cable Ø 1.5mm
(L=1500/3000/5000mm)
with spherical end
- clamp with automatic gripper



9000-KIT5-1.5-(color)
9000-KIT5-3-(color)
9000-KIT5-5-(color)

Kit Includes

- screw gripper
- plastic cup
- steel cable Ø 1.5mm
(L=1500/3000/5000mm)
with spherical end
- flaring bracket



9000-KIT6-1.5-(color)
9000-KIT6-3-(color)
9000-KIT6-5-(color)

Kit Includes

- screw gripper
- plastic canopy
- steel cable Ø 1.5mm
(L=1500/3000/5000mm)
with spherical end
- bracket with countersunk hole
with automatic gripper

2 CIRCUIT | 3 CIRCUIT TRACK

120V or 277V



Available colors: **W** = White, **B** = Black

KEY:	9000-KITx-1.5	=	59" cable
	9000-KITx-3	=	118" cable
	9000-KITx-5	=	197" cable

COMPLETE SUSPENSION KITS



- 9000-KIT8-1.5
- 9000-KIT8-3
- 9000-KIT8-5

Kit Includes

- round head ceiling attachment
- steel cable Ø 1.5mm
(L=1500/3000/5000mm)
with spherical end
- bracket with automatic gripper

TOOL



S-9000/T

Cutting Tool for Track conductors

TRACK EXAMPLE

